

ROAD & WATER CLOSURES

FRIDAY 30 NOVEMBER

Mandurah CHRISTMAS Pageant



JOIN US AT THE EVENT

- 6.00pm Community Christmas Pageant
- 7.00pm Live stage entertainment, interactive nativity scene and workshops
- 7.30pm Santa's Grotto opens
- 8.30pm Spectacular fireworks



Mandurah Bridge

The Mandurah Bridge will be closed for the duration of the Christmas Pageant, and will re-open once safe to do so.

Road Closures

From 5.00pm - 9.00pm the following road closures will apply:

- Mandurah Tce between Pinjarra Rd and Hackett St
- Tuckey St, closed between Sutton St and Mandurah Tce
- Sholl St between Pinjarra Rd and Gibson St
- Smart St between Barrack Ln and Mandurah Tce.
- Barracks Ln between Sholl St and Pinjarra Rd.
- Church St between Sholl St and Sutton St.

Local access granted until 5.30pm:

- Gibson St and Cooper St closed between Mandurah Tce and Sholl St
- Pinjarra Rd, Leslie St and Sholl St intersection
- Pinjarra Rd, between Leighton Pl roundabout to Leslie St intersection

Water Closures

Water closures from 8.00pm - 9.00pm:

- Within a 250m radius of the firing point for the fireworks beside the war memorial
- Entrance to Mandurah canals

Taxi Ranks

The Mandurah Tce and Tuckey St taxi ranks will be closed during the road closure. A temporary taxi rank will be set up in Mewburn Centre car park.

ACROD

Temporary additional accessible parking will be located and managed by volunteers at the Mewburn Centre car park off Sutton St.

Parking Closures

Parking closures will apply. Signage will be installed 10 days prior to the event. Please check signage for details.

For more information on road closures please phone 0437 487 248.

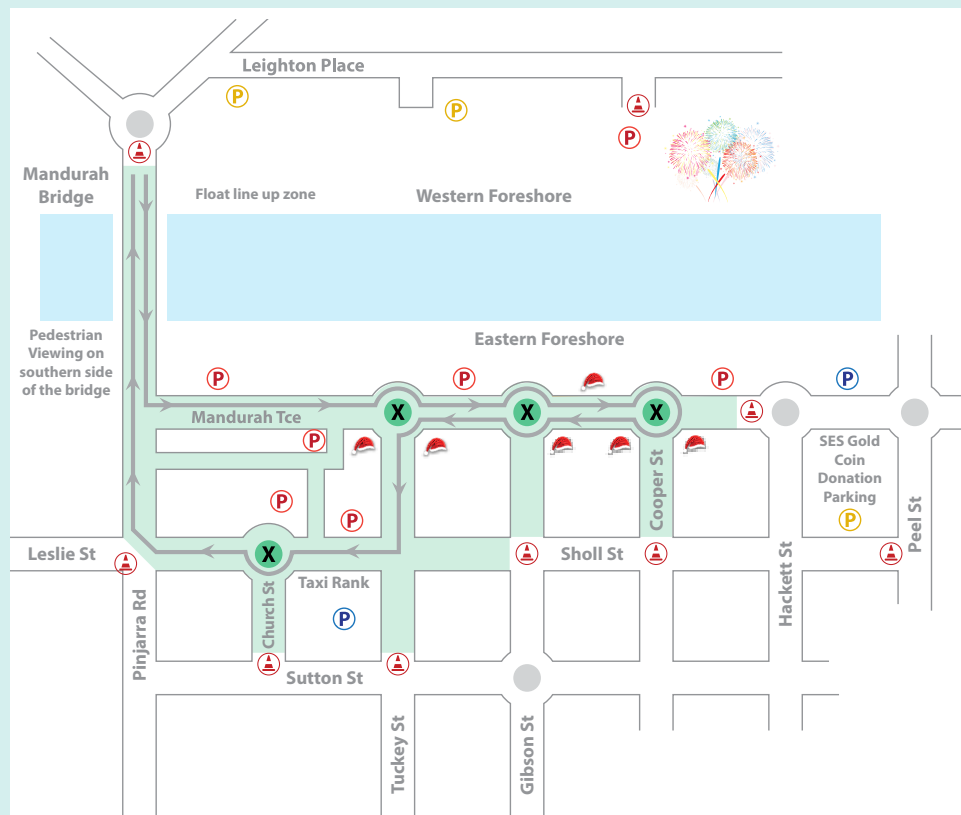

➔ Pageant Route

P Car park operational during pageant

P Gold coin charity parking

♿ Temporary additional ACROD Parking

⚠ Road closure

P Car park closed

🎅 Optimal viewing locations

Car park and street parking along the pageant route must be cleared by 5pm

christmasinmandurah.com.au